

A	FOR CONSTRUCTION	EK	25.02.14
REVISIONS			

WIND RATED TO W41

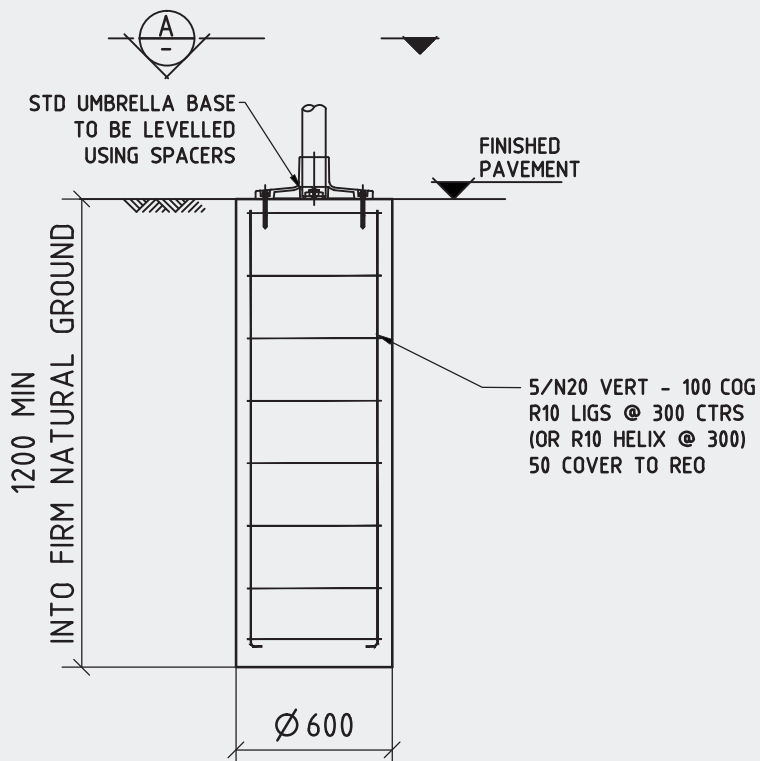

FOOTING OPTION A - BORED PIER

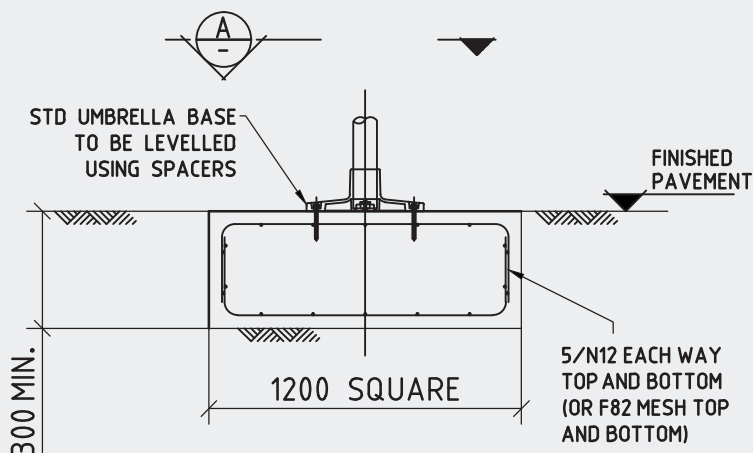

FOOTING OPTION B - PAD FOOTING

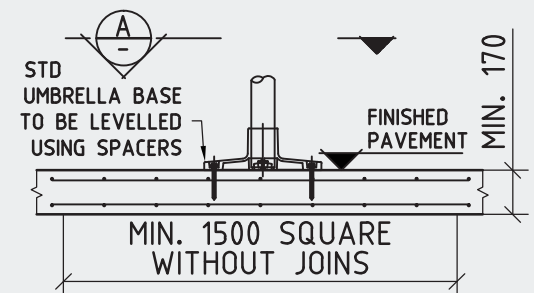

FOOTING OPTION C - EXISTING SLAB

## NOTES

- 1: THIS FOOTING DETAIL IS SUITABLE FOR FOUNDING IN NATURAL UNDISTURBED MATERIAL WITH A MINIMUM ALLOWABLE BEARING CAPACITY OF 100kPa.
- 2: IF FOOTING IS IN FILL MATERIAL PLEASE REFER TO SKYSPAN UMBRELLA FOR SITE SPECIFIC FOOTING DESIGN.
- 3: THIS FIXING DETAIL IS NOT APPLICABLE FOR CANTILEVER UMBRELLAS.
- 4: ALL WORKMANSHIP AND MATERIALS TO BE IN ACCORDANCE WITH AS3600.
- 5: EXCAVATIONS TO BE CLEAN + FREE FROM LOOSE MATERIAL.
6. CONCRETE  $f'c = 25\text{MPa}$ .
7. MAXIMUM AGGREGATE SIZE TO BE 20mm.
8. CONCRETE SHOULD BE VIBRATED AFTER POURING, AND KEPT DAMP FOR AT LEAST 7 DAYS TO ASSIST CURING.

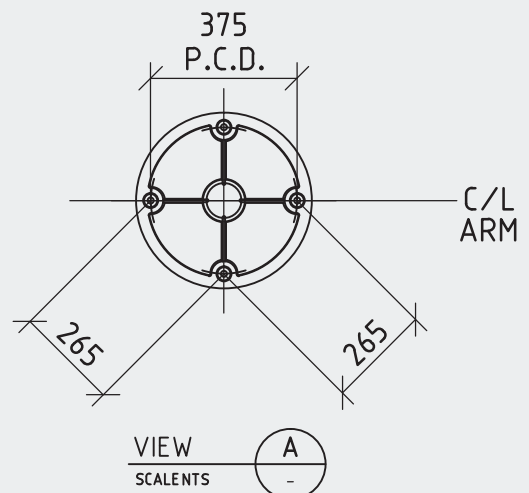

## TYPICAL H.D. BOLT DETAILS

4/M12 Gr4.6 GALV. H.D. BOLTS 110 MIN EMBEDMENT 100  
MIN EDGE DISTANCE USE RAMSET 101 RESIN OR EQUIV.

<div>Project Name</div> <div>3m SQUARE TYPHOON UMBRELLA</div>	<div>This document is copyright and remains the property of Skyspan Shade Pty. Ltd It must not be used or copied without the written consent of Skyspan Shade Pty. Ltd.</div>				
<div>Title</div> <div>GENERAL ARRANGEMENT WITH FOOTING DETAILS</div>	<div>Date:</div> <div>FEB 14</div>		<div>Drawn:</div> <div>EK</div>	<div>Checked:</div> <div>GM</div>	<div>Scale</div> <div>©A4:NTS</div>
	<div>Drawing No.</div> <div>T30S—1001</div>				<div>Revision</div> <div>A</div>